

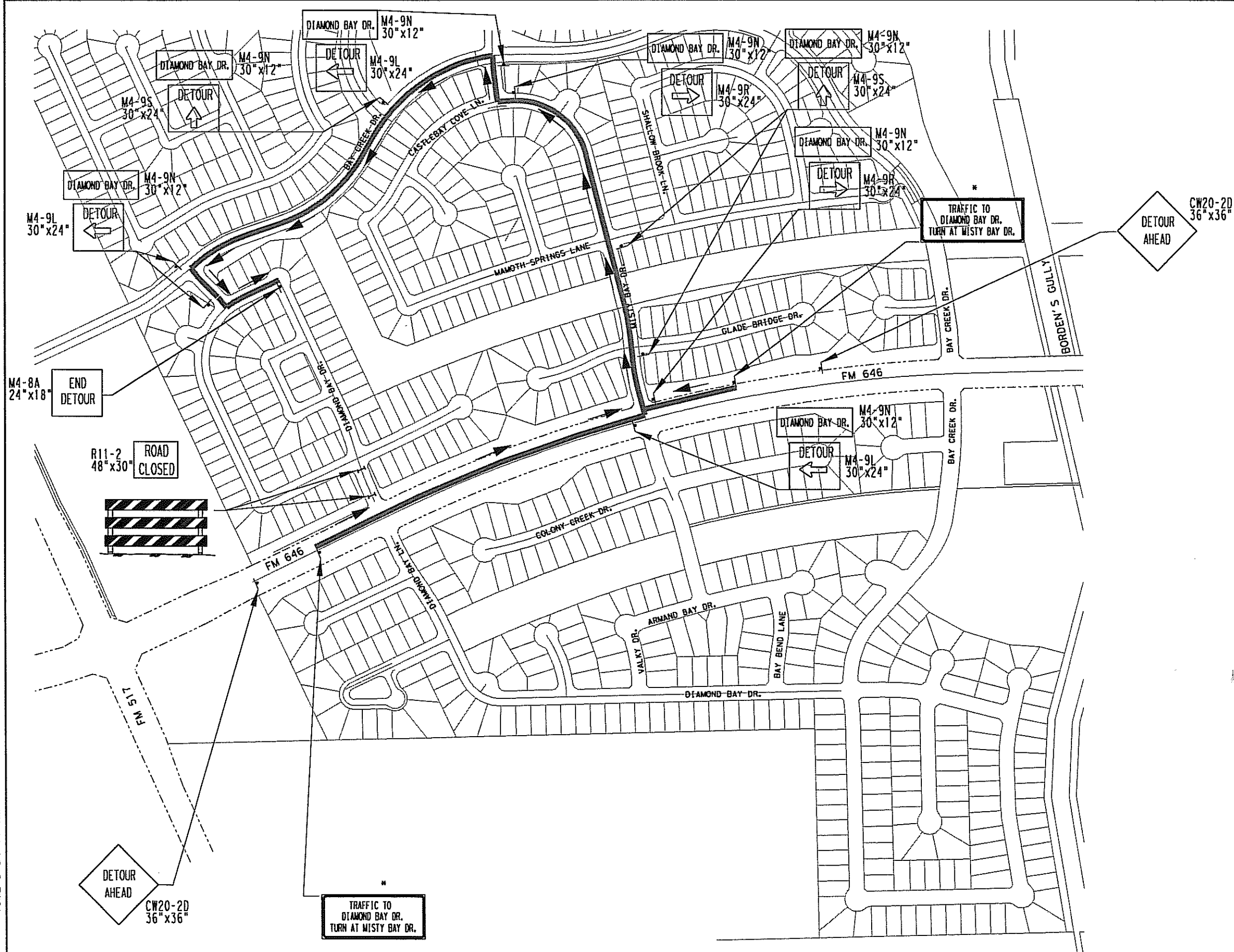

LEGEND

- PROPOSED DETOUR ROUTE
- * STATIC MESSAGE BOARD SEE TCP STANDARD



STATE OF TEXAS
 LARRY STEVEN MARR
 44187
 REGISTERED PROFESSIONAL ENGINEER
Larry Steven Marr
 23.11.08

DANNENBAUM
 ENGINEERING CORPORATION

© 2008 Texas Department of Transportation

FM 646 FROM FM 517 TO IH 45

TRAFFIC CONTROL PLAN - PHASE II
 TEMPORARY DETOUR
 DIAMOND BAY DR.

SHEET 1 OF 3

| | | | |
|-------------------|-----------|----------------|--------------|
| FED. RD. DIV. NO. | STATE | PROJECT NO. | SHEET NO. |
| 6 | TEXAS | PTF 2008 (402) | 107 |
| STATE DIST. NO. | COUNTY | CONTRACT SECT. | JOB HWY. NO. |
| HOU | GALVESTON | 3049 01 013 | FM 646 |

STATUS: 60% SUBMITTAL
 USER: Loc Dang
 P: \\1120\3777-31\top\646*detourph2-1.dgn
 TIME: 9: 54: 11 AM
 07/23/2008