



Tommy Cones  
Fire Marshal/Asst. Fire Chief

# City of League City Fire Marshal's Office

## **\*Fire Department Connection Sign Specifications\***



### Example Only

As per 2015 Edition of the International Fire Code Section 912.4

1. **Metal sign**
2. **Red background.**
3. **White reflective letters and numbers.**
4. **First line 6" high letters (F.D.C.).**
5. **Second line 3" high letters (SPRINKLERS).**
6. **Third line 4" high numbers (1411 / 1415 - Street Numbers).**
7. **Fourth line 3" high letters (W. Main - Street Name).**
8. **Sprinkler sign shall be 18" in height and 24" in width.**
9. **1/4" space between top of sign and first line.**
10. **1/2" space between first line and second line.**
11. **1/2" space between second line and third line.**
12. **1/2" space between third line and fourth line.**
13. **1/4" space between fourth line and bottom of sign.**
14. **Letter and number font to be a block style or similar.**
15. **Spacing between words shall equal one letter size.**
16. **Spacing between F.D.C. shall be period or decimal point only.**
17. **Mount sign 36" behind F.D.C. vault on a 2 3/8" aluminum fence post with cap. Mounted with two pipe post brackets as referenced in Figure 1 of this document. Sign shall be mounted 60" above the ground to the top of the sign.**
18. **F.D.C sign shall be facing the roadway and visible from both travel directions. Two signs maybe required if the FDC is installed to face the structure.**

Guidelines may be modified with written approval from the League City Fire Marshal's Office.

Page 1 of 2





Tommy Cones  
Fire Marshal/Asst. Fire Chief

# City of League City Fire Marshal's Office

(Figure 1 PIPE POST BRACKETS)

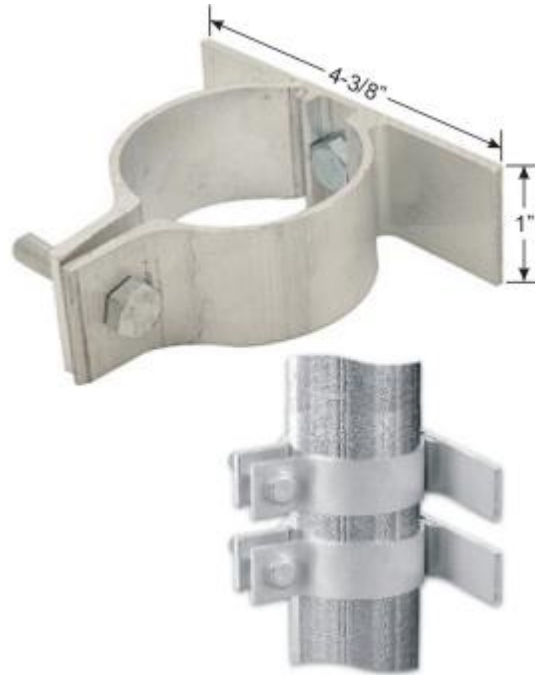

**Extruded aluminum brackets featuring an interlocking system for easy installation**

**1/8" thick pipe post brackets are strong and durable.  
Kit includes all the necessary hardware to mount 1 sign.  
Mounting Bar Size/in. 1" x 4-3/8"  
Kit Weight Appx 12oz  
Gauge .125" (1/8")  
Mounting Hardware Included**

**KIT INCLUDES:**

- 2- Interlocking Extruded Aluminum Pipe Post Brackets**
- 2- 5/16" x 3/4" Hex Head Machine Bolts to Mount Sign to Brackets**
- 2- 5/16" x 1-1/2" Hex Head Machine Bolts to Mount Brackets to Post**
- 4- 5/16" Nuts**
- 4- 5/16" Lock Washers**

